

CDI 5450-XXX-BKTOP INSTRUCTIONS

BLOCKING KIT (TOP) FOR 5450 HOT-TAP FLOWMETERS

CONTENTS

- 5450 Blocking Top
- 5450-XXX-CBL Removal Harness
 - o Size-Specific Cable
 - o (2) Shoulder Bolts



INSTRUCTIONS

1. Identify and remove the two set screws (Fig. 1) from the top assembly.
 - a. These are added safety features and will not release the top assembly once removed.
2. Install the Removal Harness by threading the two shoulder bolts where the set screws were just removed (Fig. 2).
 - a. The cable must go around the pipe.
3. Identify the two spring-loaded latches that hold the top assembly in place and press both in simultaneously (Fig. 3).
 - a. Pipe pressure will cause the top assembly to slowly move away from the base assembly, which you can assist by pulling.
 - b. To ensure the top assembly can pull far enough away, make sure the Removal Harness does not cross over the meter's ring.
4. Once the top assembly has pulled away to where the cable is taut, close both valves.
5. With both valves closed, remove the two Removal Harness screws and remove the top assembly completely (Fig. 4).
6. Install the Blocking top as you would the meter's top assembly, pushing it down until it makes an audible click, indicating it is in place (Fig. 5).
 - a. The valves must not be opened for this step.
7. Install the two set screws, from step one, into the Blocking Top (Fig. 6).

Fig. 1

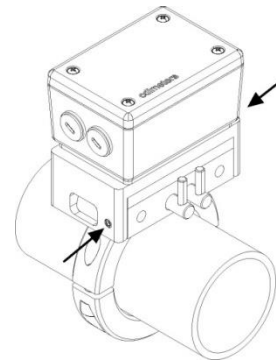

Fig. 2

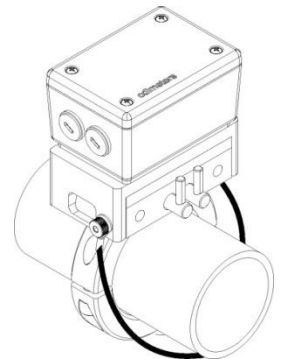

Fig. 3

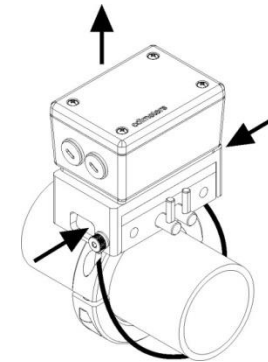

Fig. 4

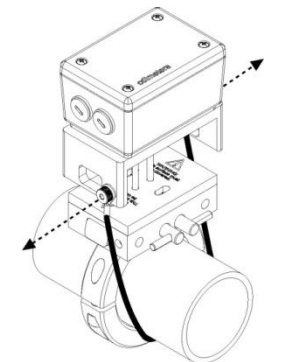

Fig. 5

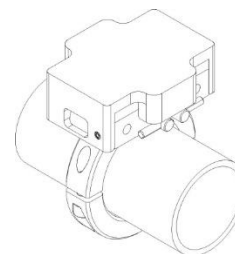
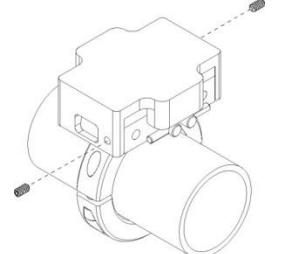

Fig. 6



cdimeters

CDI Meters, Inc.
support@cdimeters.com
866-885-2462
www.cdimeters.com